

# Technical Data

## HW 3000

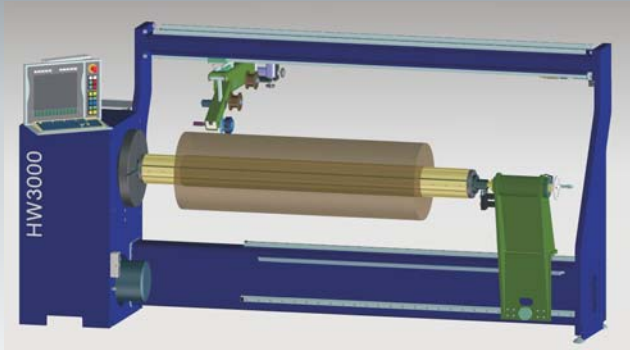

Coil diameter: max 900 mm  
 Winding width: max. 1600 mm  
 Coil weight: max. 3000 kg  
 Center height: 1000 mm  
 Winding speed: 0 - 160 rpm  
 Torque: max. 1500 Nm  
 Power winding drive: 15 kW  
 Dimensions: approx. 3750 x 2000 x 2200 mm  
 Weight: approx. 4000 kg

### Description:

- conventional winding machine for distribution transformers, traction transformers and small power transformers
- adjustable wire guide
- for round and rectangular wire
- manually adjustable tailstock
- separate electrical cabinet
- graphical user interface
- simple programming

### Accessories:

- gearbox
- manual insulation feeding system
- cutting to length device
- CNC controlled strip feeders
- endfill strip feeders
- wire tensioners for round, rectangular and CTC wires
- de-reelers
- expandable mandrels

### Advantages:

- CNC-controlled
- network connection
- remote service via internet connection
- reproducible and controlled process
- coil description by parameter files
- no permanent operator supervision required
- significant production time reduction

### Conventional winding machine

### HW 3000

Products to be manufactured with the machine

insulation material

resin

oil

Products to be manufactured with the machine	insulation material	resin	oil
Transformers			
distribution capacity up to 50 kVA	P		
distribution capacity up to 400 kVA	P		
distribution primary and secondary up to 400 kVA	P+G	●	●
distribution primary and secondary up to 4 MVA	P+G	●	●
traction transformers	P		●
reactores	P		●

Hedrich winding systems GmbH

An der Universität 2

D-30823 Garbsen

Fon: ++49 511 762- 182 28 | Fax: ++49 511 762- 182 25

E-mail: winding@hedrich.com